



"Look in the mirror in the best light."



ARTALO

Premium Mirrors
with LED Lighting

User Manual / Assembly Instructions

Contents

Parameters.....	2
What You'll Need.....	3
Safety Warnings.....	4
Before You Start Assembly.....	5
Assembly.....	6
Drilling.....	7
Hanging and Connecting the Mirror.....	8
Cleaning and Maintenance.....	10

1

Parameters

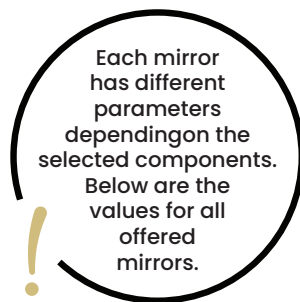

LED Color	<ul style="list-style-type: none"> · Basic LED: 6000K, 4500K, 3000K · Power LED (COB): 6500K, 4500K, 3000K · Philips LED: 6500K, 4000K, 3000K · Dual color (CCT COB LED): 2700–6500K · RGB+CCT (COB)
Energy Class	A++
Lighting Intensity	<ul style="list-style-type: none"> · Basic LED: 950–1020 lm (depending on LED color) · Power LED (COB): 1300 lm · Philips LED: 2000 lm · Dual color (CCT COB LED): 1200–1300 lm (depending on LED color) · RGB+CCT (COB): 1200–1300 lm (depending on LED color)
Number of LEDs	<ul style="list-style-type: none"> · Basic LED: 120/m · Power LED (COB): 480/m · Philips LED: 70/m · Dual color (CCT COB LED): 608/m · RGB+CCT (COB): 840/m
Power Supply	230V
Input Voltage of Power Supply	230V AC
Output Voltage of Power Supply	12–24V DC (depending on LED type)
Included in the Set	Mounting accessories
Consumption	9,6–18 W/m (depending on LED type)
Protection Degree	IP54
Glass Panel Thickness	4 mm
Mirror Thickness	38 mm
Warranty	2 years

2

What You'll Need

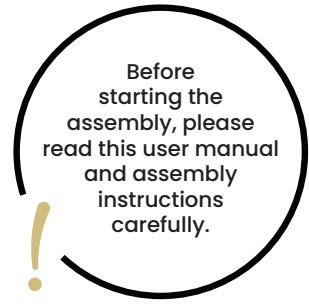

- ① Pencil
- ② Tape measure or ruler
- ③ Spirit level
- ④ Wall plugs
- ⑤ Hooks (included in the package)
- ⑥ Drill and pliers
- ⑦ Drill bit



· We recommend
performing the installation
with two people.

Failure to follow the instructions may result in the rejection of a warranty claim.

3

Safety Warnings



Caution, glass!

Be careful with the edges and corners of the mirror during assembly.
Remove protective elements only after installation.



Fragile!

The mirror is fragile. We recommend that the installation be carried out by at least two adults.



Fire Hazard!

Using LED lighting for extended periods can cause the LED strip to become very hot. Do not leave flammable objects near the mirror. Mirrors with lighting can only be mounted on non-flammable surfaces or surfaces with a low flame spread value.



Burn Hazard!

Do not touch the lighting; it can be very hot.



High Voltage!

The electrical installation must be carried out by a qualified person.

4

Before You Start Assembly

Do not place
the mirror on
a hard surface, as it
could get damaged.
Always place it
on a soft pad.

- ① Carefully unpack the mirror on a soft surface.
- ② Ensure that all components of your order are included in the package.
- ③ Place the mirror on a soft surface, such as a towel.
- ④ Remove the protective elements from the corners of the mirror and check if the corners are damaged.
- ⑤ Remove the protective film and check if the mirror surface is damaged in any way.
- ⑥ Check if the mirror is damaged in any way.

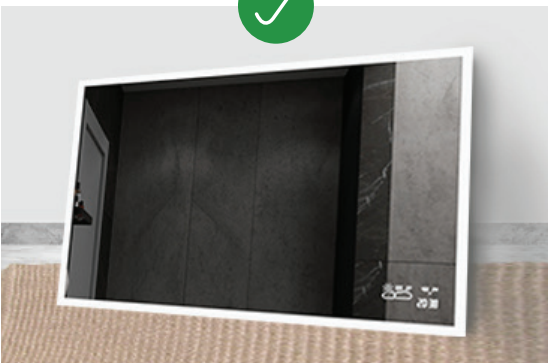

If there is any damage, contact us. Do not mount a damaged mirror. Reattach the protective elements and film after checking the corners and install with them on. Remove them again only after the mirror is installed on the wall.

5

Assembly

The distance between the marked points on the wall must match with the distance between the holes on the mirror.

- ① First, please measure the distance between the two holes in the back of the mirror.
- ② Mark the spots for drilling holes in the wall and double-check that the distance between them matches the distance you measured between the hooks.
- ③ Ensure that there are no water pipes, other pipes, or electrical wiring where you plan to drill the holes. If there are, choose a different location for installation.

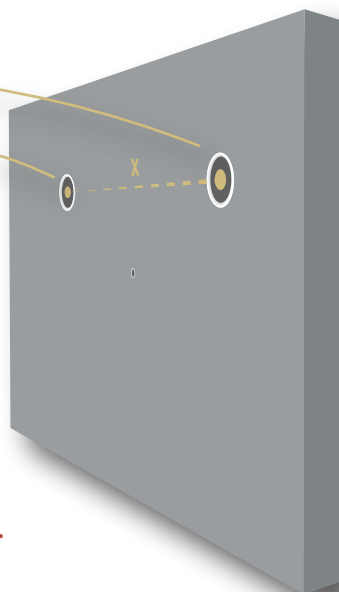
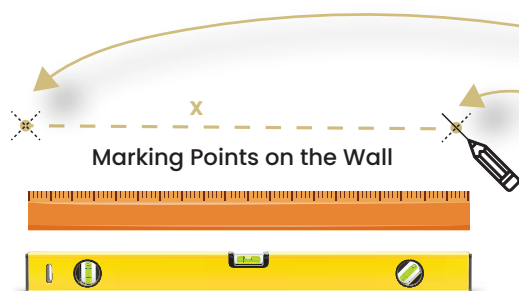

! Hang the mirror only on the designated mounting hooks.

! Do not hang the mirror on furniture or the ceiling.

6

Drilling

What You'll Need:

- 14 mm drill bit
- 14 mm wall plugs
- L-shaped hooks

- ① Drill holes in the wall at the marked spots and insert the wall plugs.
If you are drilling into drywall, please use the appropriate wall plugs for it (not included).
- ② Screw the hooks into the wall plugs so that the bent part is approximately 30 mm from the wall.

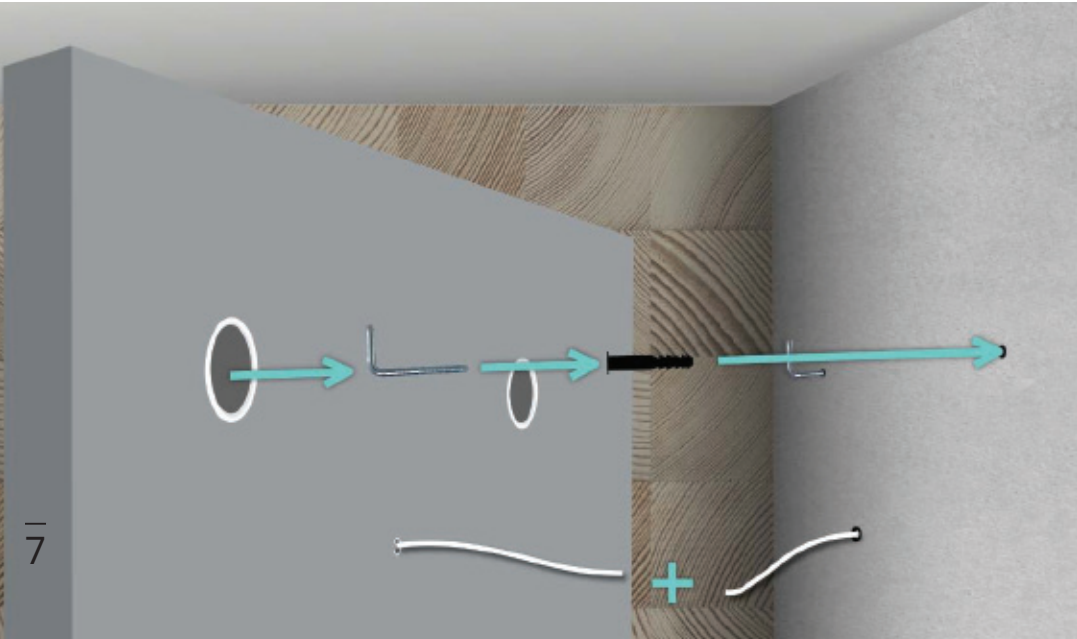
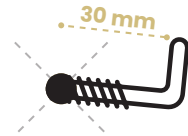

7

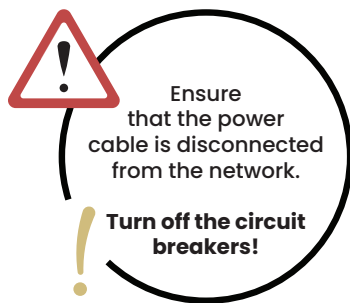

Hanging and Connecting the Mirror

Wiring

! It is necessary to follow the safety principles and procedures for working with electrical installations.

· Before connecting the mirror to the electricity, carefully check the energy label located on the back of the mirror. The network must match the information on the label.

! The mirror may only be connected by a qualified person.

- The light source and other components of the mirror are not replaceable.
- The set does not include a terminal block.
- The circuit to which the mirror is connected must be equipped with a residual current device (RCD).

- ① Before connecting the mirror to electricity, turn off the circuit breakers.
- ② Connect to the terminal block.
- ③ Turn on the circuit breakers.

Hanging

- ① Ensure that the mirror is correctly mounted on the hooks.
- ② Then slowly hang the mirror.
- ③ Once the mirror is hung, you can remove the remaining protective elements from the surface and corners of the mirror.

8

Cleaning and Maintenance

- ① Use a solvent to remove any remaining protective film from the mirror.
- ② For daily care of glass surfaces, use only products that are intended for this purpose or a microfiber cloth.
- ③ Do not clean the glass with aggressive (silicone or acidic) cleaning agents that can damage the glass surface.



All products marked with this symbol are waste electrical and electronic equipment (WEEE as per Directive 2012/19/EU), which should not be mixed with unsorted household waste. Instead, you should protect human health and the environment by disposing of your waste equipment at a designated collection point for the recycling of waste electrical and electronic equipment, as determined by the government or local authorities. Proper disposal and recycling help prevent potential negative impacts on the environment and human health. Contact your installer or local authorities for more information on the location and conditions of such collection points.

Thank you for
choosing
our product.



Artalo design s.r.o.

Lískovec 393

738 01 Frýdek-Místek

Czech Republic

CIN: 10888560, TIN: CZ10888560

E-mail: info@artalo.com

www.artalo.com